

Vorderansicht

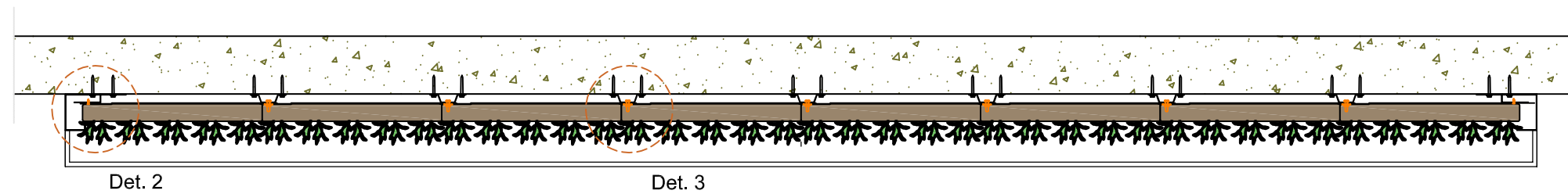

Querschnitt B-B

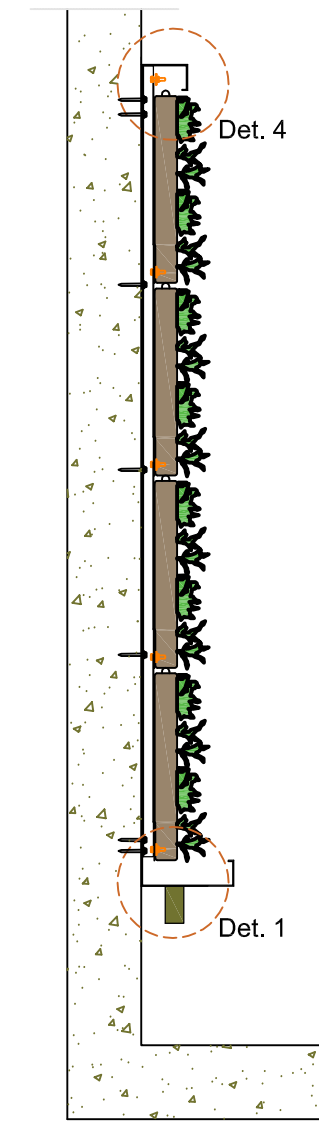

Querschnitt A-A

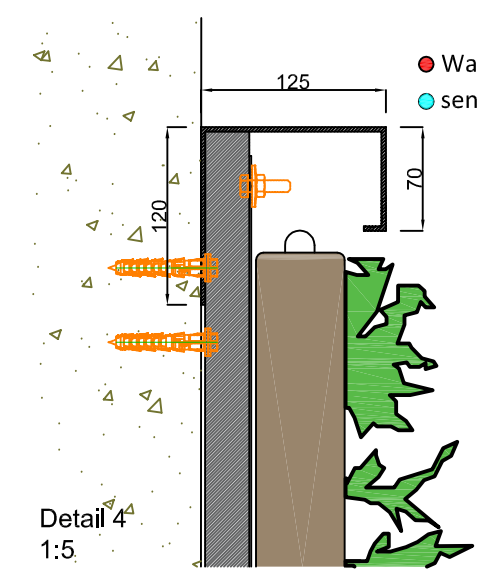
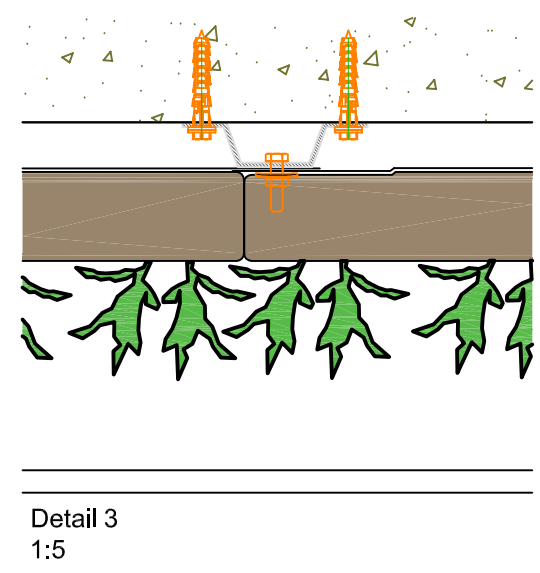
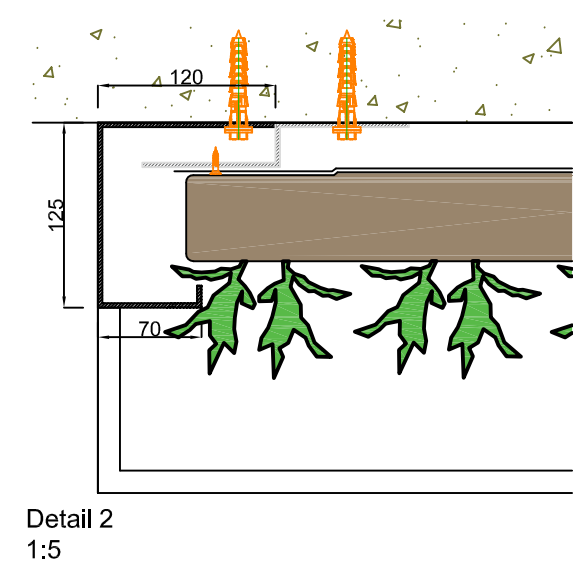
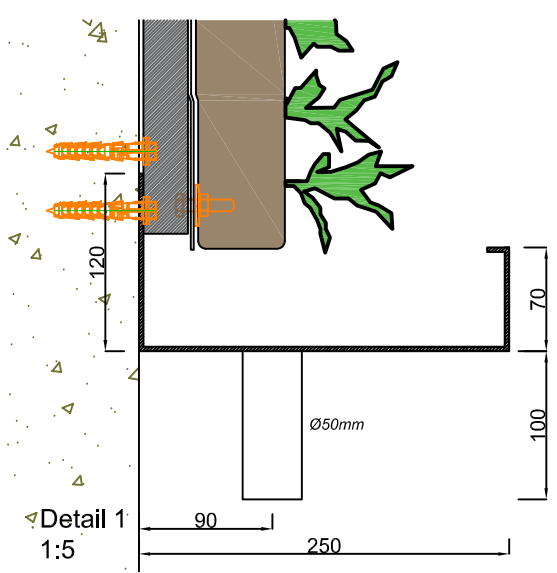

● Wasserleitung 3/4" Innengewinde DN15-32 Pex/Al/Pex  
● sensor kabel Feuchtesensor Typ CY 2 x 0,5-1,0mm<sup>2</sup>

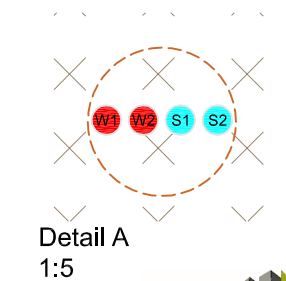

Detail A  
1:5

- Cradle to Cradle  
zertifiziert
- Max. gesättigtes  
Gewicht
- 45 kg/m<sup>2</sup>
- Webbasiertes  
Bewässerungssystem
- Pflanzenpflegesystem
- Garantie Flexipanel
- 10 Jahre

**sempergreen wall**  
www.sempergreenwall.com

**Beschreibung**  
SemperGreenwall  
Indoor

**Maßstab**  
1:20 / 1:5

**Format**  
A3

**Datum**  
25.01.2021

**Zeichnung Nr.**  
SGWI-S01

5080

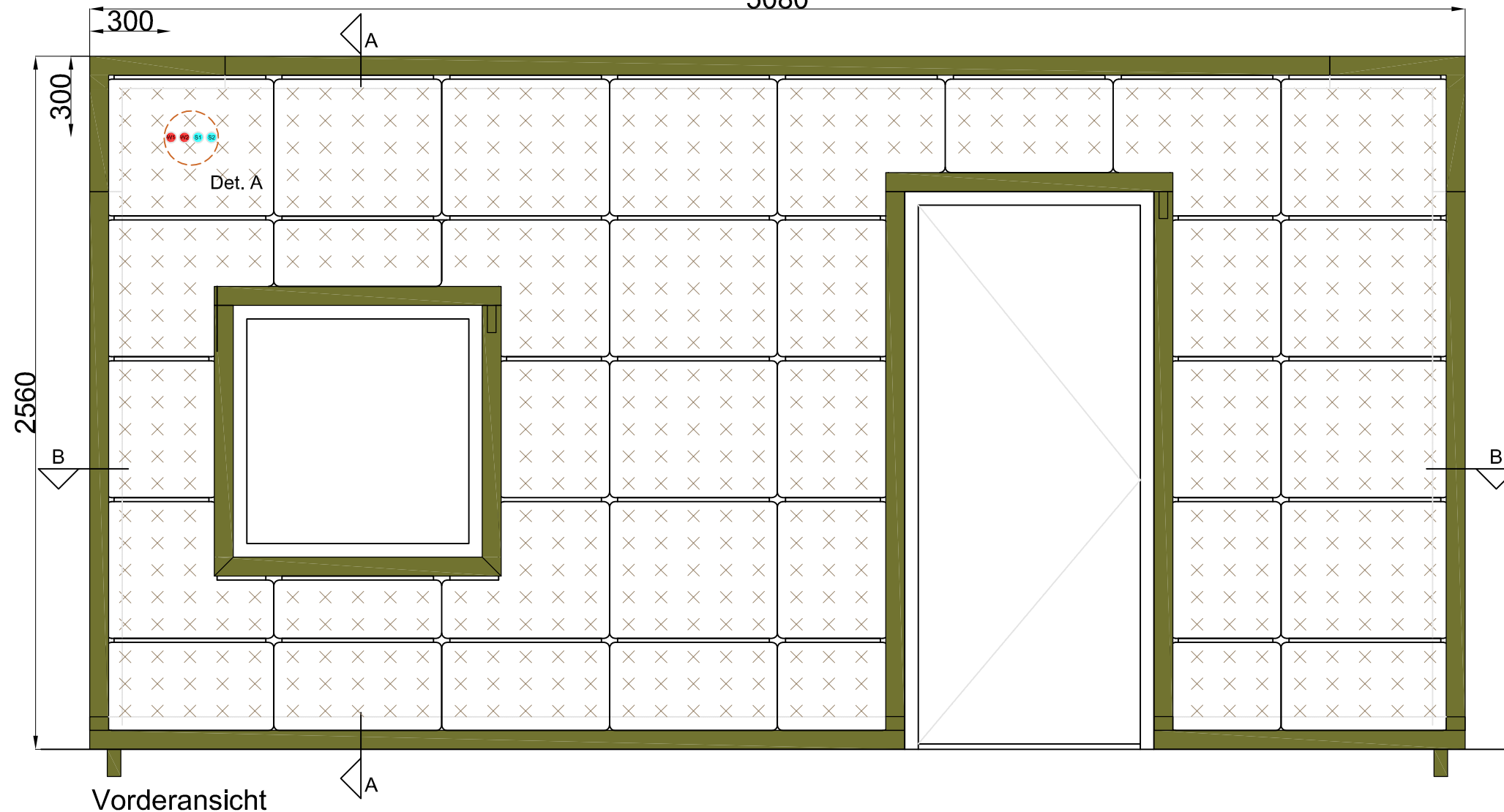

Vorderansicht

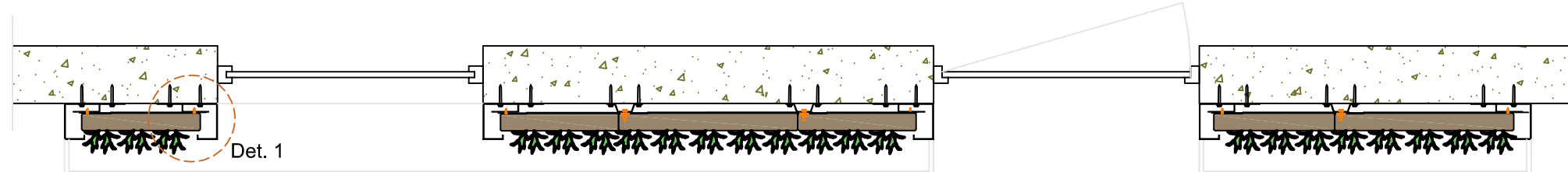

Querschnitt

B-B

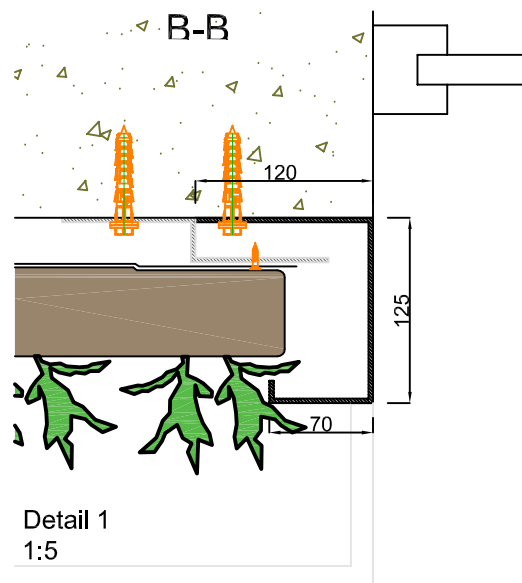

Detail 1  
1:5

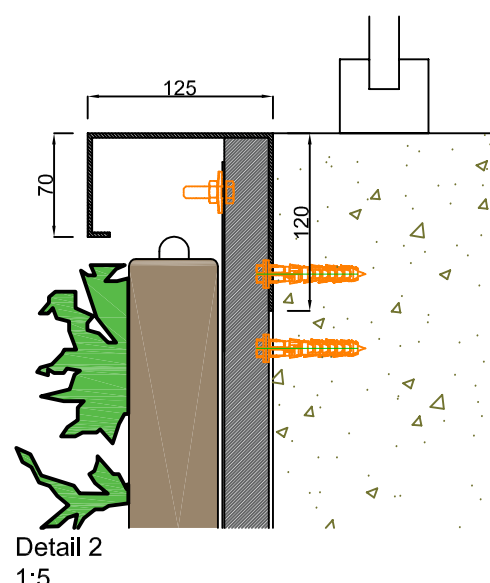

Detail 2  
1:5

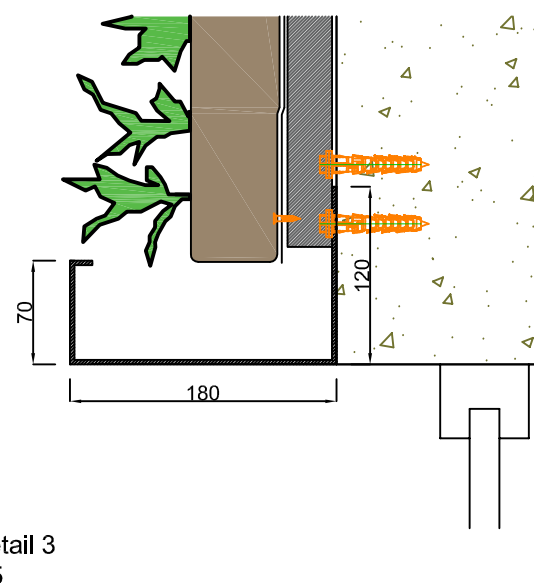

Detail 3  
1:5

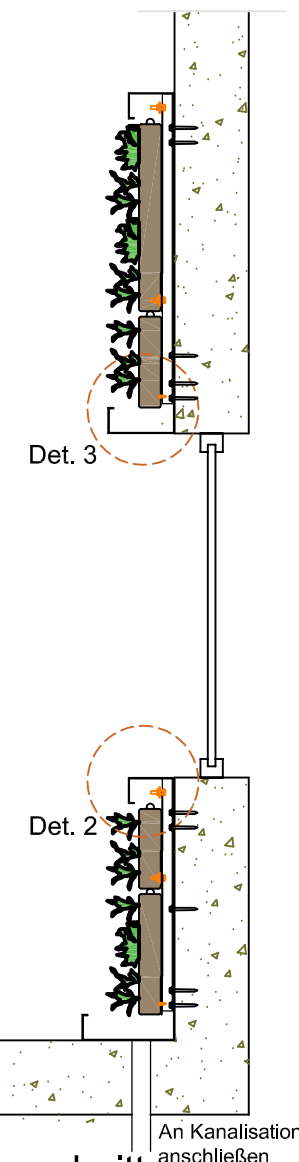

Querschnitt  
A-A

Cradle to Cradle  
zertifiziert



Max. gesättigtes  
Gewicht



Webbasiertes  
Bewässerungssystem



Garantie Flexipanel

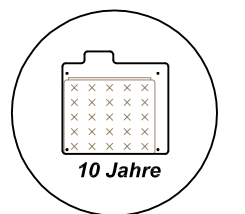

- Wasserleitung 3/4" Innengewinde DN15-32 Pex/Al/Pex
- sensorkabel Feuchtesensor Typ CY 2 x 0,5-1,0mm<sup>2</sup>

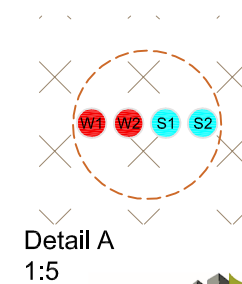

Detail A  
1:5



**Beschreibung**  
SemperGreenwall  
Indoor Fenster- / Türdetails

**Maßstab**  
1:20 / 1:5

**Format**  
A3

**Datum**  
25.01.2021

**Zeichnung Nr.**  
SGWI-S02

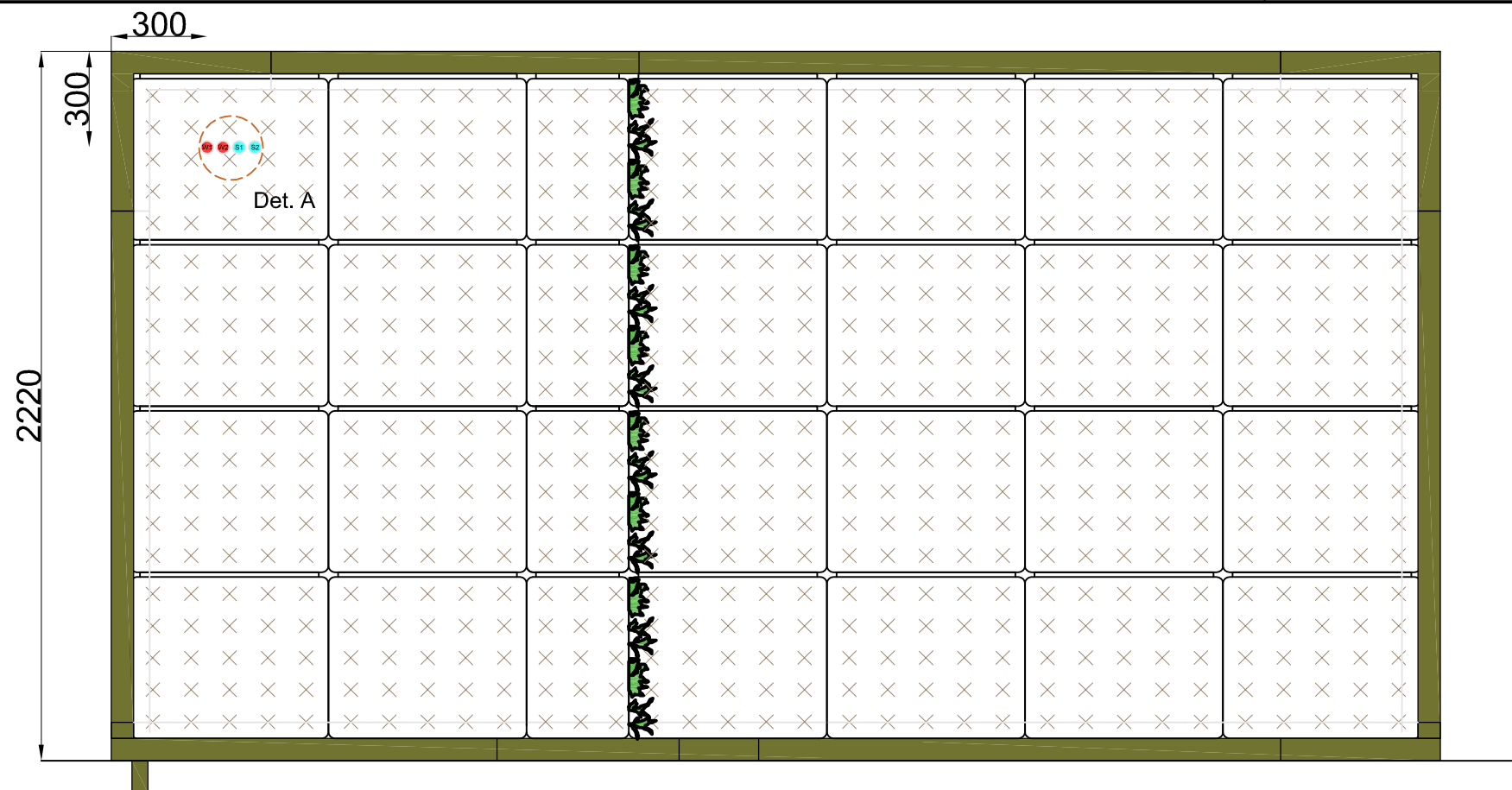

Ansicht A.

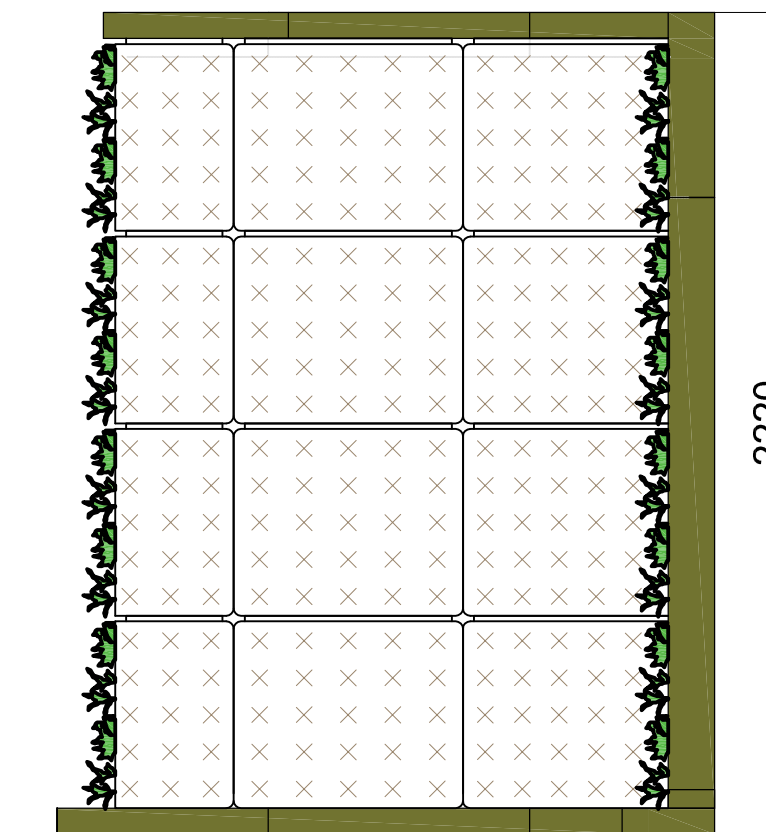

Ansicht B.

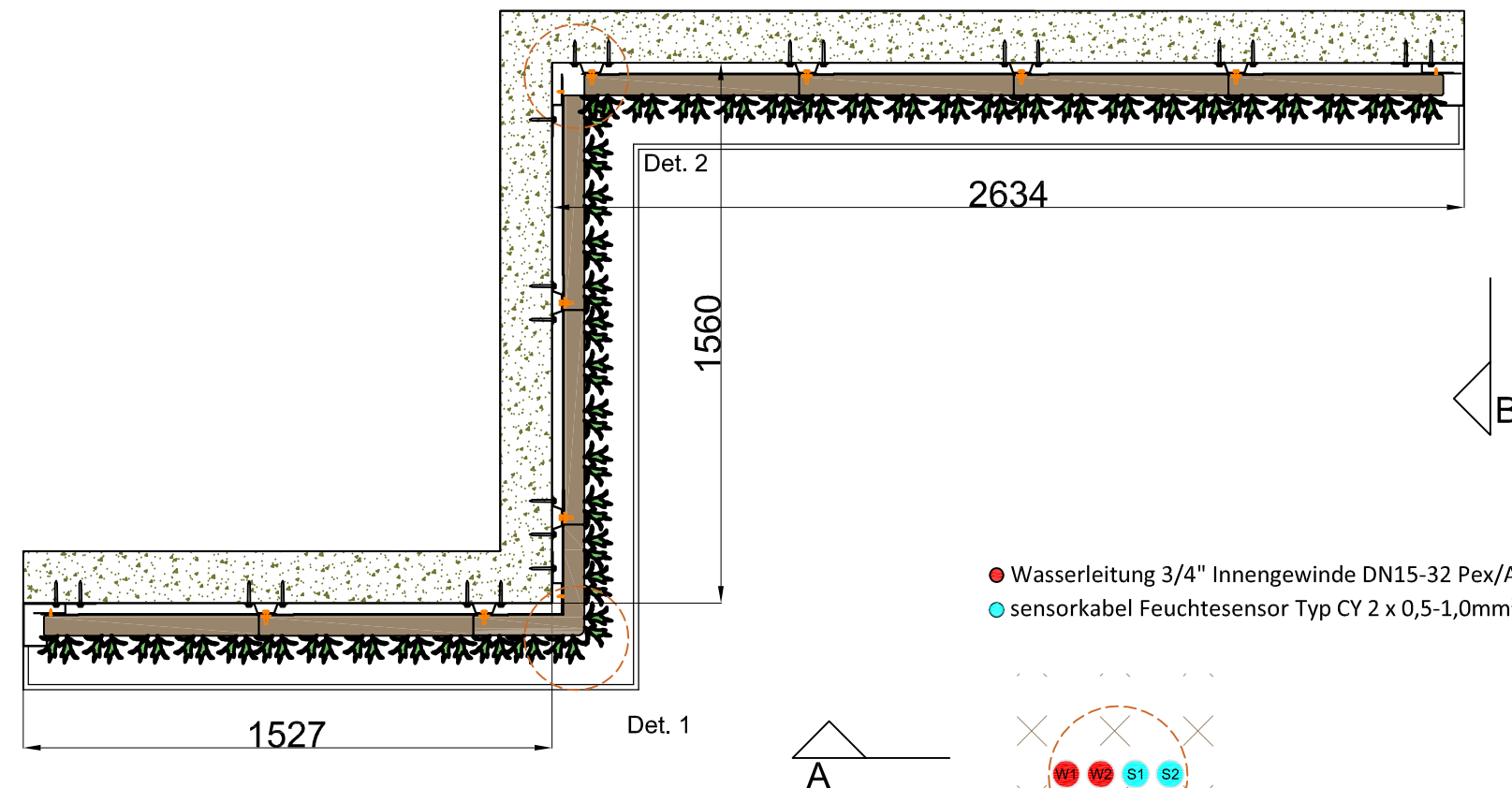

- Wasserleitung 3/4" Innengewinde DN15-32 Pex/Al/Pex
- sensor kabel Feuchtesensor Typ CY 2 x 0,5-1,0mm<sup>2</sup>

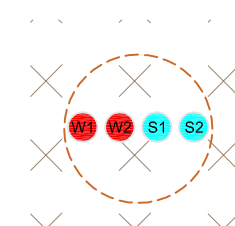

Detail A  
1:8

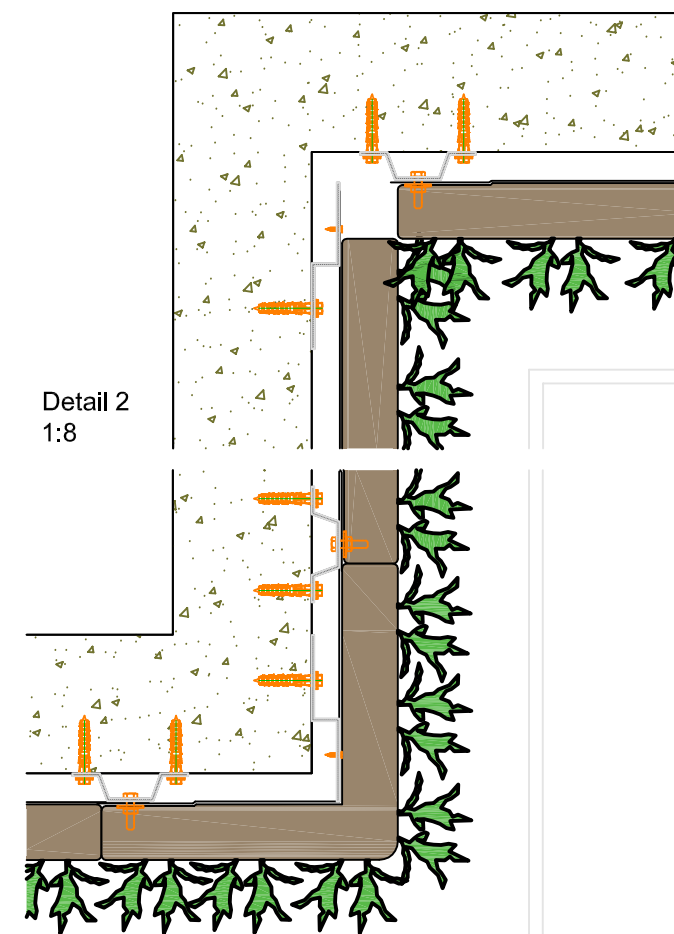

Detail 2  
1:8

Detail 1  
1:8

Cradle to Cradle  
zertifiziert

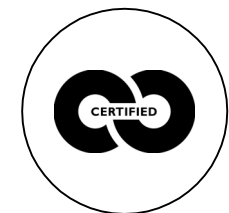

Max. gesättigtes  
Gewicht



Webbasiertes  
Bewässerungssystem



Garantie Flexipanel

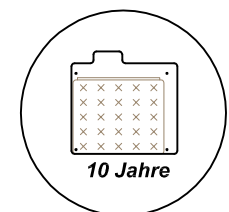

**Beschreibung**  
SemperGreenwall  
Indoor Eckdetails

**Maßstab**  
1:20 / 1:8

**Format**  
A3

**Datum**  
25.01.2021

**Zeichnung Nr.**  
SGWI-S03

www.sempergreenwall.com

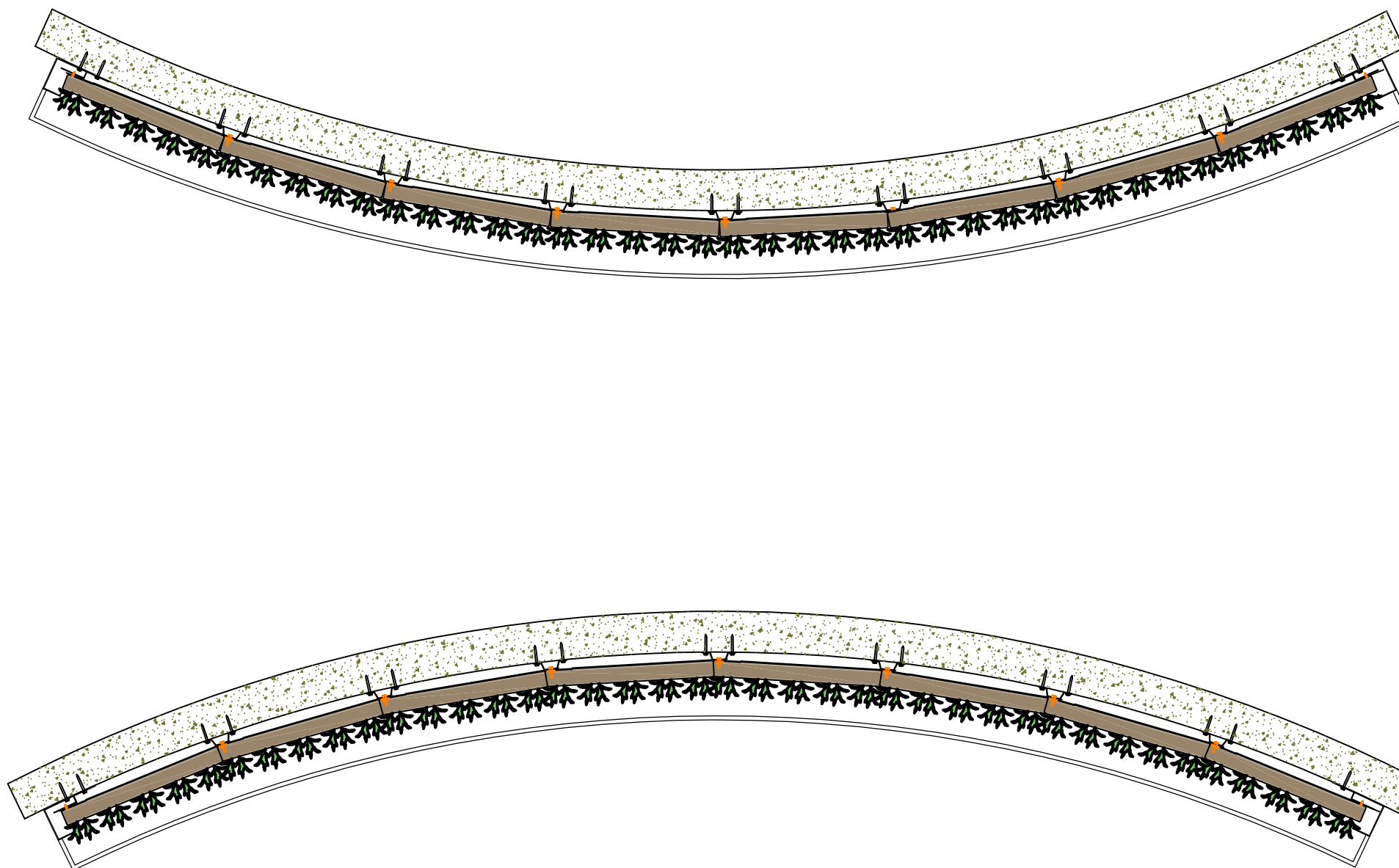

Cradle to Cradle  
zertifiziert



Max. gesättigtes  
Gewicht



Webbasiertes  
Bewässerungssystem



Garantie Flexipanel

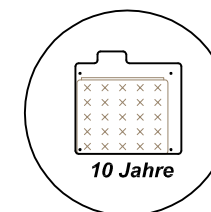

**Beschreibung**  
SemperGreenwall  
Indoor gebogene wand

**Maßstab**  
1:20

**Format**  
A3

**Datum**  
25.01.2021

**Zeichnung Nr.**  
SGWI-S04